

Product Outline

- High reliability DC/DC converter transformer.
- Ideally used in Electric compressor for Car Air-conditioner, Converter on ECU, BMS, LED head light driving, IGBT and other electronic devices.
- Operating temperature range(Including self temperature rise):-40°C to +125°C.
- Custom design is also available.
- RoHS Compliant.

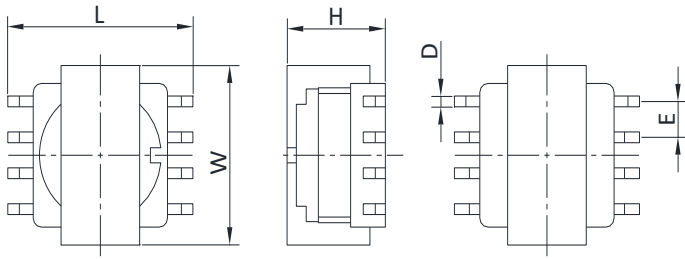

Dimensions



Schematics

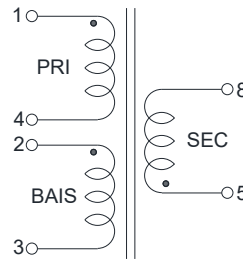

Recommended Land Patterns

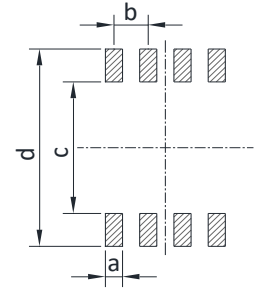

Unit: mm

Type	L	W	H	D	E	a	b	c	d	Packaging (pcs/reel)
TER1006	11.3 Max.	10.0 Max.	6.0 Max.	0.6	2.0	1.0	2.0	8.0	12.0	500

Dimensions without tolerance are typical.

Electrical Characteristics(at 25°C)

Part Number	Inductance(uH) 1kHz/1V	DCR(mΩ)			Hi-Pot 50/60Hz,0.5mA,2S
	(1-3) (short Pin2+4)	PRI	BIAS	SEC	PRI-SEC
TER1006-A001	33.7±25%	72 Max.	110 Max.	135 Max.	AC 600V