

### Product Outline

- High reliability DC/DC converter transformers.
- Ideally used in Electric compressor for Car Air-conditioner, Converter on ECU, BMS, LED head light driving, IGBT and other electronic devices.
- Operating temperature range(Including self temperature rise):-40°C to +125°C.
- Custom design is also available.
- RoHS Compliant.

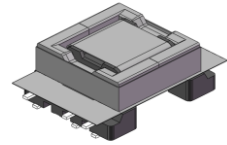

### Dimensions

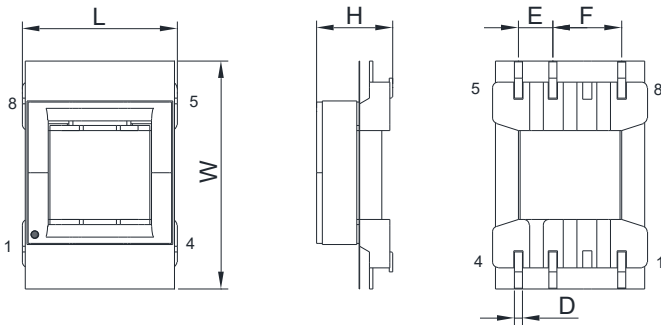

### Schematics Recommended Land Patterns

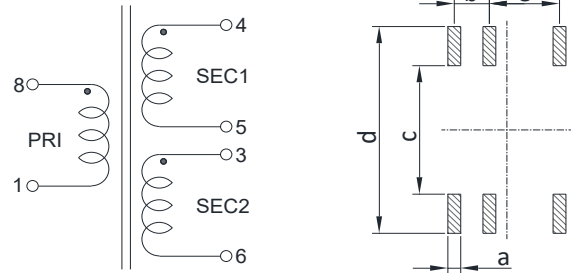

Unit: mm

Type	L	W	H	D	E	F	a	b	c	d	e	Packaging (pcs/reel)
TEFD1206	13.5±0.4	20.0±0.4	7.0 Max.	0.7	3.0	6.0	1.8	3.0	12.5	18.1	6.0	400

Dimensions without tolerance are typical.

### Electrical Characteristics(at 25°C)

Part Number	Inductance(uH) 100kHz,0.1V	LK(uH) 100kHz,0.1V	DCR(mΩ)	Turn Ratio	Hi-Pot 0.5mA,60S	
	PRI	PRI(Short others)	PRI	PRI:SEC1:SEC2	PRI-SEC	COIL-CORE
TEFD1206-A001	252±40%	1.2 Max.	280 Max.	1:0.421:1.263	DC 2800V	DC 2800V