

### Product Outline

- High reliability DC/DC converter transformer.
- Ideally used in Electric compressor for Car Air-conditioner, Converter on ECU, BMS, LED head light driving, IGBT and other electronic devices.
- Operating temperature range(Including self temperature rise):-40°C to +125°C.
- Custom design is also available.
- RoHS Compliant.

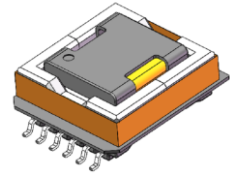

### Dimensions

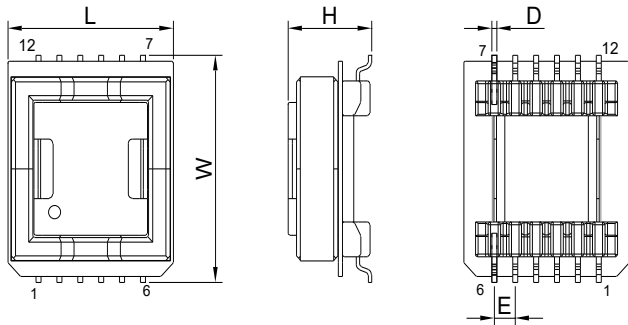

### Schematics

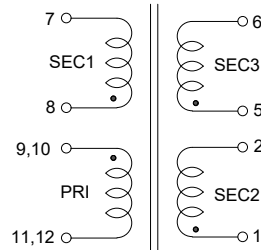

### Recommended Land Patterns

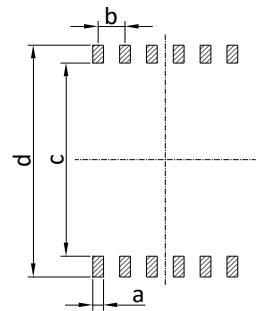

Unit: mm

Type	L	W	H	D	E	a	b	c	d	Packaging (pcs/reel)
TEFD1910	20.5 Max.	25.3 Max.	10.5 Max.	0.6	2.5	1.0	2.5	21.6	25.6	200

Dimensions without tolerance are typical.

### Electrical Characteristics(at 25°C)

Part Number	Inductance(uH) 100kHz,1V	LK(uH) 100kHz,1V	DCR (mΩ)	Turns Ratio	Hi-Pot 50/60Hz,1mA,60S		
	PRI	PRI(Short others)	PRI	PRI:SEC1:SEC2:SEC3	PRI,SEC1-SEC2, SEC3	SEC2-SEC3	COIL-CORE
TEFD1910-A001	10±18%	0.2 Max.	34 Max.	1:0.857:3.714:3.714	AC 2500V	AC 1500V	AC 2500V