

## Product Outline

- Ideally used in Electric Vehicle Charging Station as DC/DC converter inductors.
- Operating temperature range(Including self temperature rise):-40°C to +105°C.
- Custom design is also available.
- RoHS Compliant.

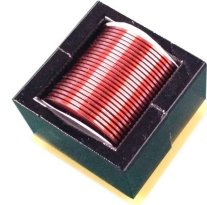

## Dimensions (Unit: mm)

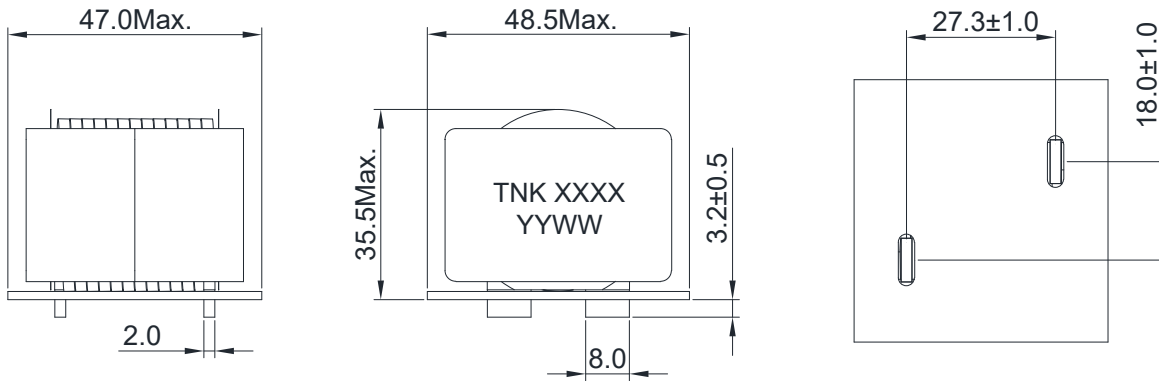

Dimensions without tolerance are typical.

## Schematics

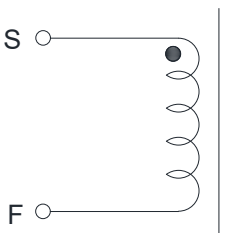

## Recommended Land Patterns

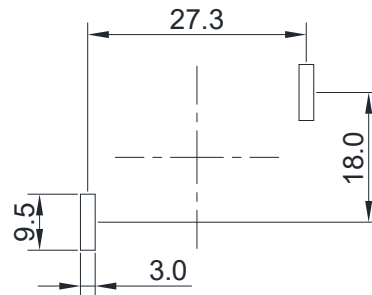

## Electrical Characteristics(at 25°C)

Part Number	Inductance(uH) 10kHz,0.1V DC=0A	LK(uH) 10kHz,0.1V DC=110A	Rated current
	(S-F)	(S-F)	(S-F)
DEQ4135-I001	22.1±15%	10.0 Ref.	45A Typ.

## Customized Product