

Product Outline

- Ideally used in Automotive On-board Charger as DC/DC converter modules.
- Custom design is also available.
- RoHS Compliant.
- Operating temperature range(Including self temperature rise):-40°C to +125°C.

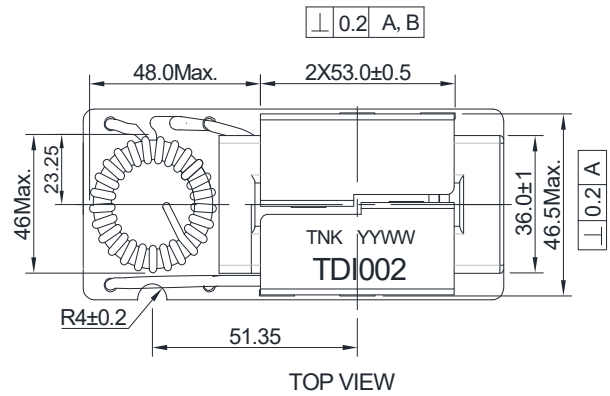

Dimensions (Unit: mm)

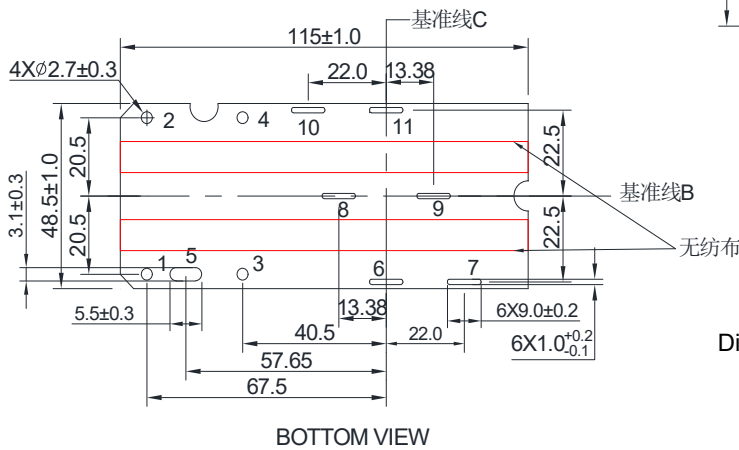
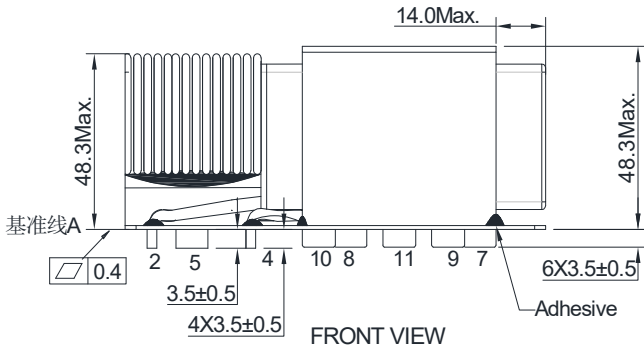

Dimensions without tolerance are typical.

Schematics

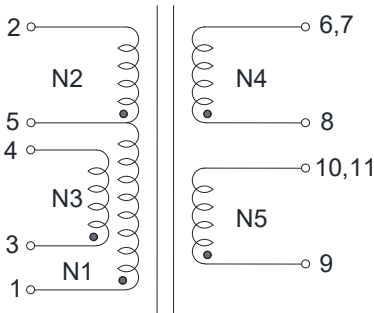

Customized Product

Electrical Characteristics(at 25°C)

Part Number	Inductance(uH) 100kHz, 0.1V	LK(uH) 100kHz, 1V	DCR(mΩ)		Turn Ratio	HI-POT 2mA, 3S			
	(1-5)	(1-2) (Short 3+4)	(1-2)	(3-4)	N2:N3:N4:N5	(1~5)-(6~11)	N1-N3	N4-N5	Coil-Core
TDI1002	30±25%	50 Max.	31.5 Max.	17.0 Max.	14:15:1:1±3%	DC 4200V	DC 4200V	DC 1200V	DC 4200V

All specifications are subject to change without notice.