

## Product Outline

- High saturation current and low DCR.
- Broadband impedance characteristics and good superimposition characteristics.
- The range of filter video noise from MHz to GHz.
- Small size and thin form factor.
- It is mainly used in PoC(Power Over Coaxial) lines for Automotive camera system.
- Operating Temperature Range: -55°C To +125°C(including self-temperature rise).
- RoHS compliant.

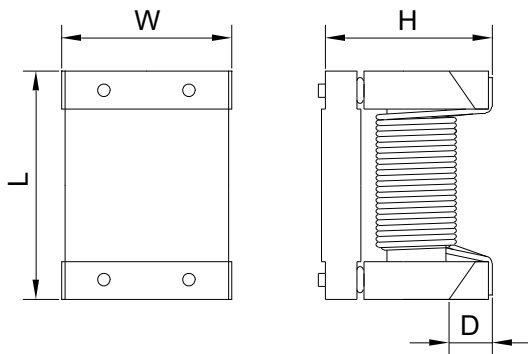

## Dimensions



## Recommended Land Patterns

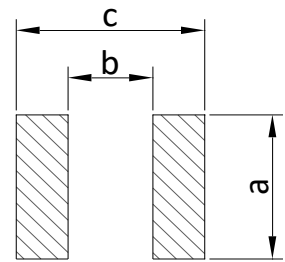

Unit: mm

Type	L	W	H	D	E	a	b	c	Packaging (pcs/reel)
CWFP3225	3.2±0.3	2.5±0.3	3.0±0.3	0.5	0.58	3.2	1.8	4.0	4000

Dimensions without tolerance are typical.

## Product Identification

CW   F   P   3225   -   4R7   M  
 (1)   (2)   (3)   (4)   (5)   (6)

(1) Product Series No.

(2) Material: Ferrite Core

(3) Dimensions: 3225=3.2 x 2.5mm(L x W)

(4) PoC Application.

(5) Inductance Value.

100=10×10<sup>0</sup>uH=10uH   4R7=4.7uH

(6) Tolerance:

M=±20%

## Electrical Characteristics(at 25°C)

Part Number	Inductance ① (uH)	Inductance tolerance	DCR ② (mΩ) Max.	DCR ② (mΩ) Typ.	Isat ③ (A) Typ.	Irms ④ (A) Typ.
CWFP3225-2R2M	2.2	±20%	180	144	1.00	1.22
CWFP3225-4R7M	4.7	±20%	100	80.0	0.72	1.50
CWFP3225-100M	10	±20%	150	120	0.45	1.30
CWFP3225-150M	15	±20%	400	320	0.35	0.725
CWFP3225-220M	22	±20%	300	240	0.38	1.00
CWFP3225-470M	47	±20%	900	720	0.30	0.50

**Note:**

- ① Inductance tested at 100kHz,0.25V using an Agilent/HP 4192A or equivalent.
- ② DCR measured on a micro-ohmmeter.
- ③ Isat: The DC current at which the inductance decreases by 30% of its initial value.
- ④ Irms: The DC current at which temperature rise is  $\Delta T=40^{\circ}\text{C}$ ( $T_a=25^{\circ}\text{C}$ ).