

### Product Outline

- Excellent saturation current handling to be up to 27.6A.
- Low DC resistance keeps power losses to a minimum.
- For DC/DC converter applications.
- Ideally used in thin-screen TV, LCDs, AV equipment and other electronic devices.
- Custom design is also available.
- RoHS compliant.

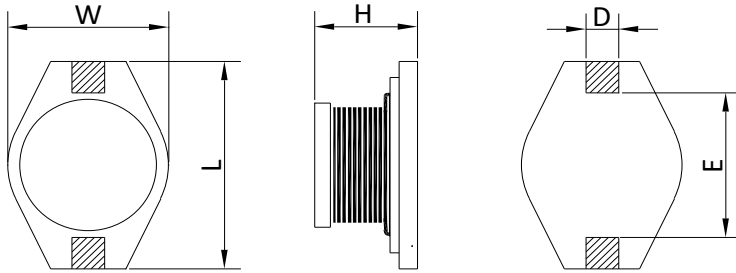

### Dimensions



### Recommended Land Patterns

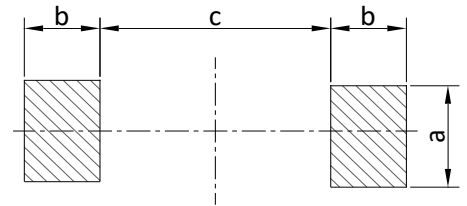

Unit: mm

Type	L	W	H	D	E	a	b	c	Packaging (pcs/reel)
CDB1807	18.0±0.5	15.24 Max.	7.11 Max.	2.54	12.65	3.0	3.0	12.4	300

Dimensions without tolerance are typical.

### Product Identification

CDB   1807   -   100   M  
 (1)   (2)   (3)   (4)

(1) Product Series No.

(2) Dimension Symbol:

1807=18.0 x 7.11mm (L x H)

(3) Inductance Value:

100=10×10<sup>0</sup>uH=10uH   4R7=4.7uH

(4) Tolerance:

K=±10%   L=±15%   M=±20%   P=±25%   N=±30%

### Electrical Characteristics(at 25°C)

Part Number	Inductance ① (uH)	Inductance tolerance	DCR ② (mΩ) Max.	Isat ③ (A)	Irms ④ (A)
CDB1807-1R0M	1.0	±20%	9.00	27.6	8.60
CDB1807-2R2M	2.2	±20%	14.0	18.5	7.10
CDB1807-3R3M	3.3	±20%	18.0	14.5	6.20
CDB1807-5R6M	5.6	±20%	20.0	12.5	5.30
CDB1807-8R2M	8.2	±20%	29.0	10.3	4.80
CDB1807-100M	10	±20%	31.0	9.40	4.30
CDB1807-150M	15	±20%	36.0	7.50	4.00
CDB1807-220M	22	±20%	47.0	6.50	3.50
CDB1807-330M	33	±20%	66.0	5.20	3.00
CDB1807-470M	47	±20%	86.0	4.20	2.60
CDB1807-680M	68	±20%	130	3.70	2.30
CDB1807-101M	100	±20%	190	3.00	1.80
CDB1807-151M	150	±20%	250	2.50	1.50
CDB1807-221M	220	±20%	380	2.00	1.20
CDB1807-331M	330	±20%	560	1.70	1.00
CDB1807-471M	470	±20%	850	1.50	0.82
CDB1807-681M	680	±20%	1100	1.20	0.72
CDB1807-102M	1000	±20%	1800	0.95	0.56

Note:

- ① Inductance tested at 100kHz,0.1Vrms using an Agilent/HP 4192A or equivalent.
- ② DCR measured on a micro-ohmmeter.
- ③ Isat: The DC current at which the inductance decreases by 10% of its initial value.
- ④ Irms: The DC current at which temperature rise is  $\Delta T=40^{\circ}\text{C}$ ( $T_a=25^{\circ}\text{C}$ ).